

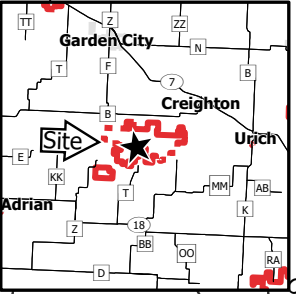

Settle's Ford Conservation Area

Conservation Commission of the State of Missouri ©

7,363 acres in Bates/Cass County - Last Updated - 8/25/2025

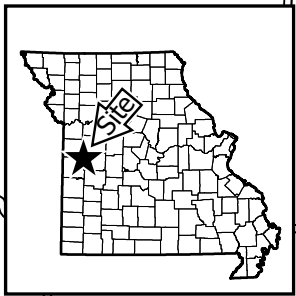
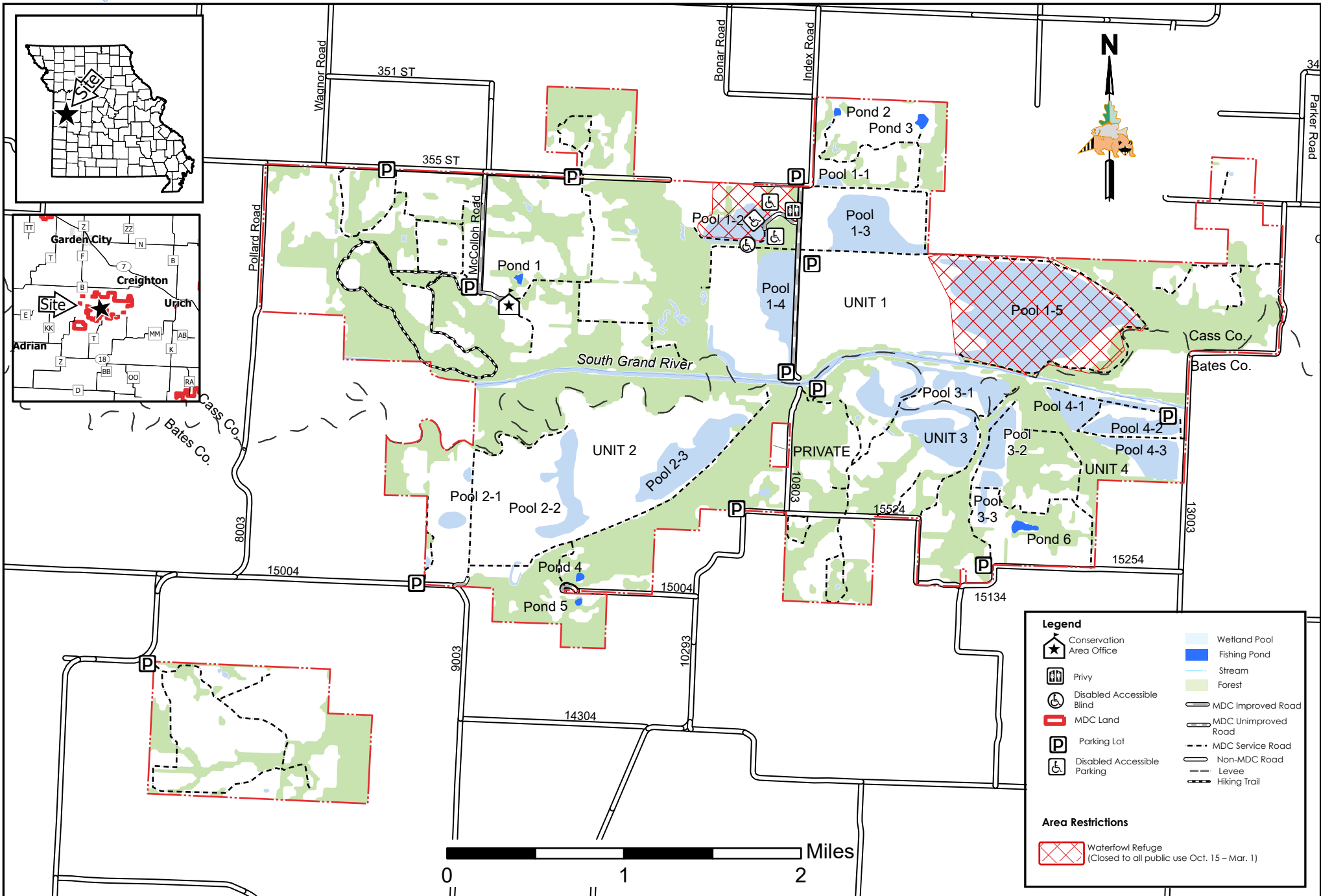

Legend

- Conservation Area Office
- Privy
- Disabled Accessible Blind
- MDC Land
- Parking Lot
- Disabled Accessible Parking
- Wetland Pool
- Fishing Pond
- Stream
- Forest
- MDC Improved Road
- MDC Unimproved Road
- MDC Service Road
- Non-MDC Road
- Levee
- Hiking Trail

Area Restrictions

- Waterfowl Refuge (Closed to all public use Oct. 15 - Mar. 1)

MAP DISCLAIMER: Although all data in this map have been compiled by the Missouri Department of Conservation, no warranty, expressed or implied, is made by the department as to the accuracy of the data and related materials. The act of distribution shall not constitute any such warranty, and no responsibility is assumed by the department in the use of these data or related materials.