

BRYSON'S HOPE CONSERVATION AREA AND W.R. KEARN MEMORIAL CONSERVATION AREA

**PETTIS COUNTY
572 ACRES**

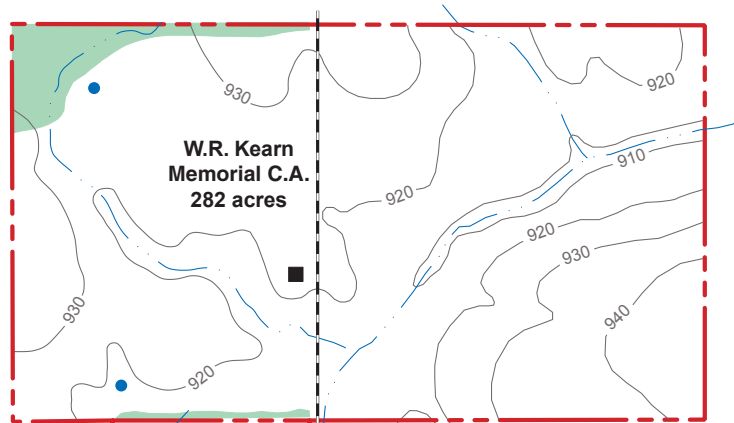

VICINITY MAP

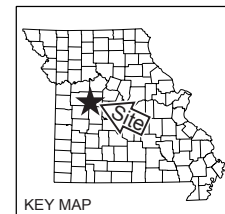
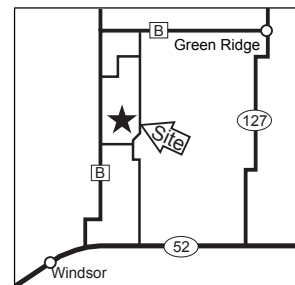

KEY MAP

SCALE

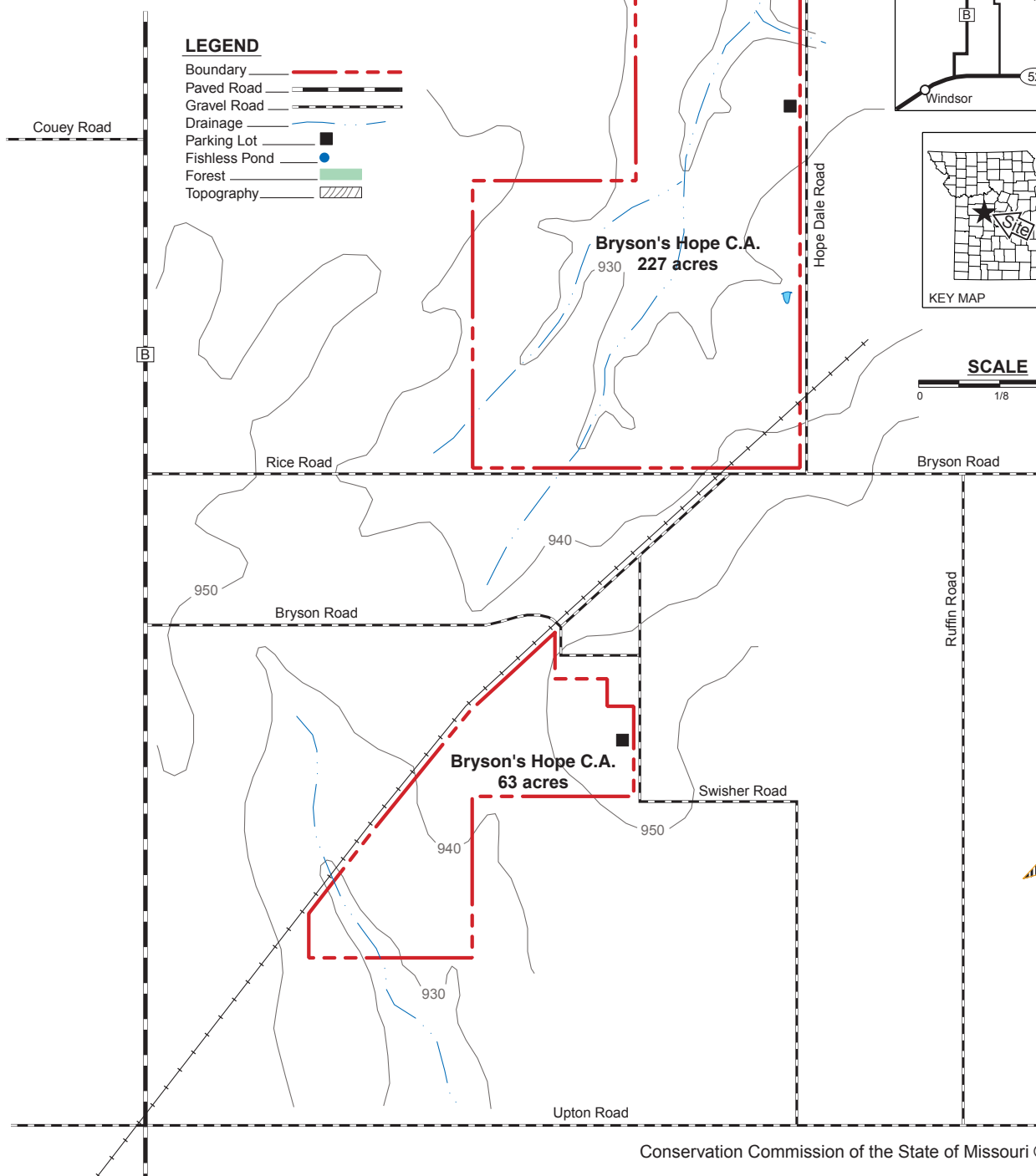

LEGEND

- Boundary
- Paved Road
- Gravel Road
- Drainage
- Parking Lot
- Fishless Pond
- Forest
- Topography

